

# Fords.

SALES | LETTINGS | NEW HOMES

London Road High Wycombe HP11 1HA





London Road High Wycombe HP11 1HA

**£255,000**

Penthouse Apartment - Sophisticated Contemporary Living with Exceptional Park Views

A beautifully presented two-bedroom top floor apartment, perfectly positioned to capture sweeping views across Kingsmead Park and the picturesque surrounding countryside.

## Description

Designed with comfort and style in mind, the apartment features two spacious double bedrooms, a luxurious family bathroom, and an impressive open-plan kitchen, dining, and living area. The expansive UPVC windows flood the space with natural light, while the dual-aspect design enhances the sense of openness and connection to the outdoors.

Step outside onto the large private balcony - an idyllic setting for morning coffee or evening relaxation while taking in the stunning parkland views.

Further highlights include central heating, an allocated parking space with gated entry parking, ample visitor parking, and lift access throughout the building.



## Situation

Westfields House enjoys an enviable position on London Road, just east of High Wycombe's vibrant town centre. The nearby Retail Park offers an array of amenities, including an M&S Food Hall, McDonalds, and Wickes, while the wider town provides a perfect balance of heritage, convenience, and connectivity.

For commuters, access is effortless - with two junctions of the M40 close by and direct Chiltern Railways services whisking you to London Marylebone in as little as 27 minutes.



# Floor Plans

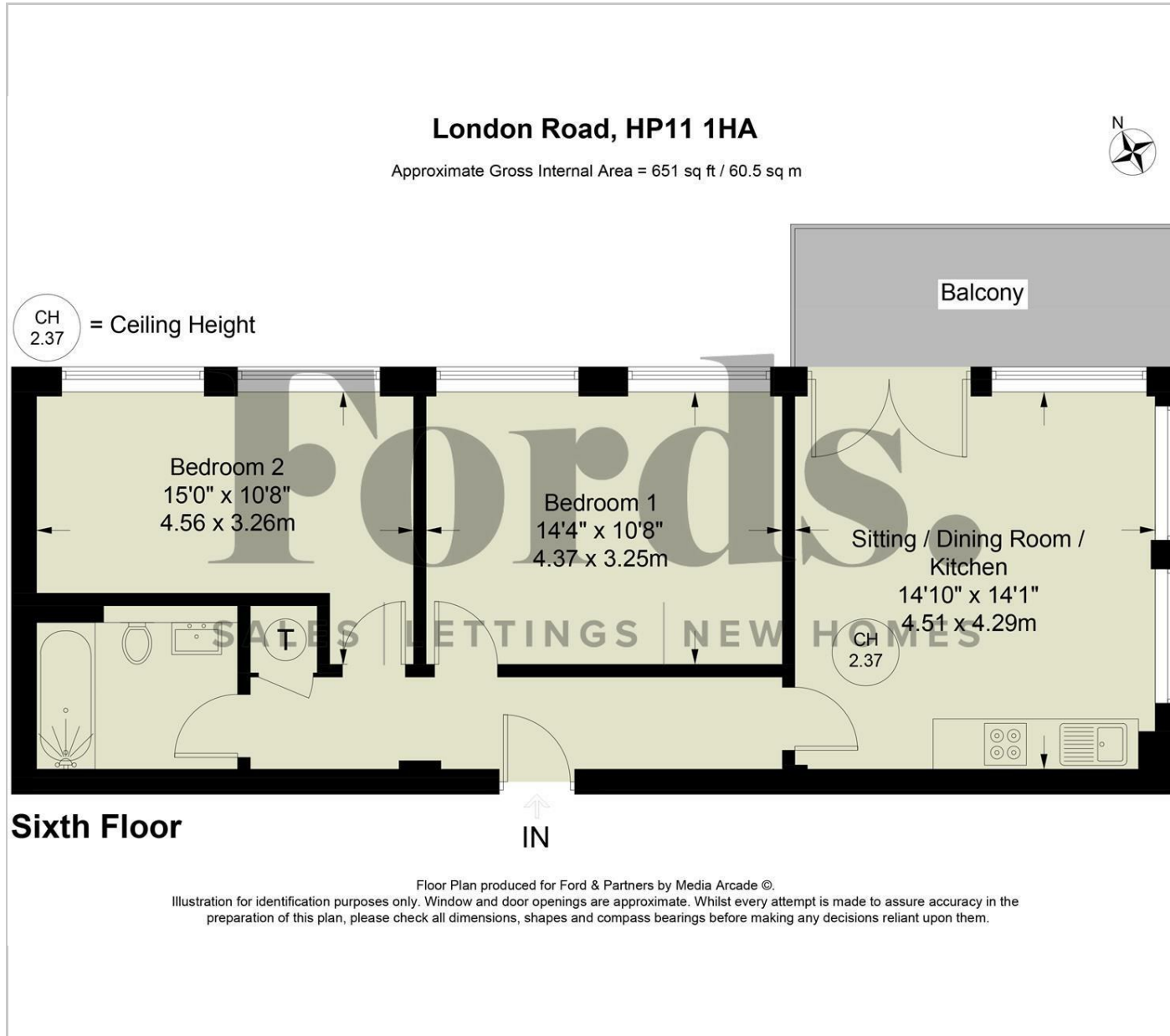

# Area Map

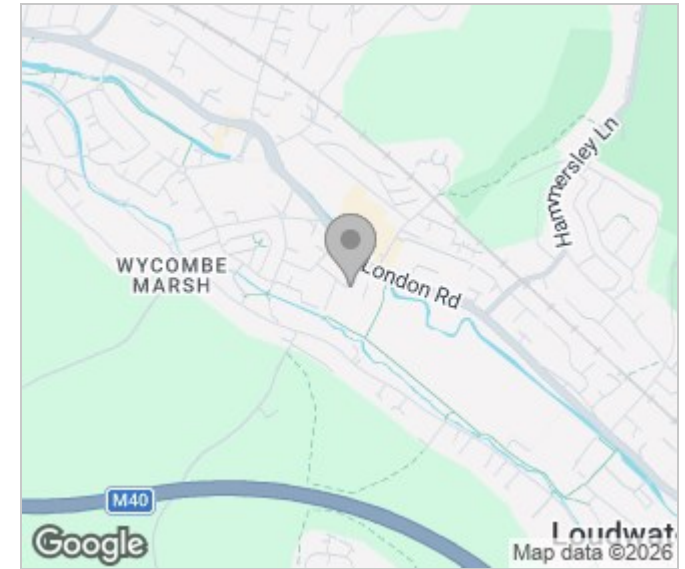

# Energy Performance Graph

